

- 35014 1 FLUIDIC PLANT

- 28103/2 2 CONTROL DESK AND ELECTRICAL INSTALLATION
Control desk with electrical installation

- 0012 3 MOTORIZED DE-COILER

- 11001E 4 HEADING AND WELDING BENCH

- 55010 5 55010-STRAIGHTENER FEEDER

- 1P 6 STRIP INTRODUCER - GUIDE

- 48203 7 HF WELDING HEAD

- 48202 8 SCRAPING HEAD FOR HF

- 0016 9 FLYING SHEAR

- 0017 10 FINAL CUTTING DIE

- 48201E 11 HF WELDING UNIT

- 28001/1 12 SET OF FORMING ROLLS
Series of tempered and rectified rolls



Machine for beam for desks



Beam for desks

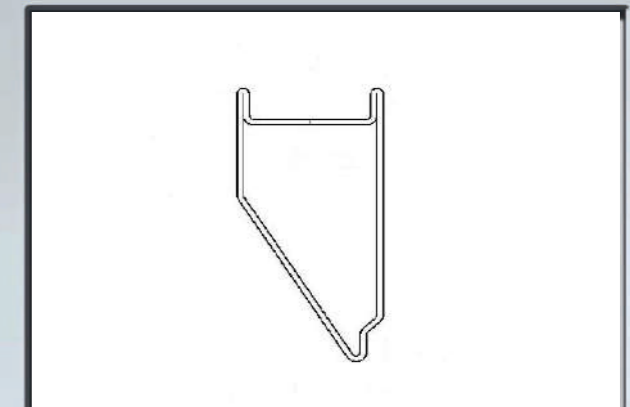

Desk beam section



16300

PM sas
Via Montegrappa, 109
30030 Salzano (Ve) Italy
Tel +39 0415745047
fax +39 0415745058
www.pm-eng.info
pm@pm-eng.info

16300-MACHINE OF BEAM FOR WRITING DESKS



Desk beam roll forming



Beam forming rolls

Material: Fe 42 - galvanized		
Maximum thickness	2,5	mm
Length	1000-4100	mm
Line speed	10	m/min
Line colour	Blu 5015	RAL



De-coiler



Strip introducing group



Unloading bench



Control board

16300

